



# HYDRAULIC FLOOR TYPE PRESS 50 TONNE

## MODEL NO: YK50F

Thank you for purchasing a Sealey product. Manufactured to a high standard, this product will, if used according to these instructions, and properly maintained, give you years of trouble free performance.

**IMPORTANT:** PLEASE READ THESE INSTRUCTIONS CAREFULLY. NOTE THE SAFE OPERATIONAL REQUIREMENTS, WARNINGS & CAUTIONS. USE THE PRODUCT CORRECTLY AND WITH CARE FOR THE PURPOSE FOR WHICH IT IS INTENDED. FAILURE TO DO SO MAY CAUSE DAMAGE AND/OR PERSONAL INJURY AND WILL INVALIDATE THE WARRANTY. KEEP THESE INSTRUCTIONS SAFE FOR FUTURE USE.



Refer to  
instruction  
manual



Wear protective  
gloves



Wear face  
mask



Wear protective  
clothing



Wear safety  
footwear



Warning:  
crushing of  
hands

## 1. SAFETY

### 1.1. GENERAL SAFETY

- ✓ Familiarise yourself with the applications, limitations, and hazards peculiar to the press.
- ✓ Maintain the press in good condition (use an authorised service agent).
- ✓ Replace or repair damaged parts. Use recommended parts only. Unauthorised parts may be dangerous and will invalidate the warranty.
- ✓ Keep the press clean for best and safest performance.
- ✓ Locate the press in an adequate working area for its function, keep area clean and tidy and free from unrelated materials and ensure there is adequate lighting.
- ✓ Ensure the work piece is correctly secured before operating the press.
- ✓ Ensure that all fittings are tight before each use.
- ✓ Remove ill fitting clothing. Remove ties, watches, rings, loose jewellery and contain long hair.
- ✓ Keep hands and body clear of the work table when operating the press.
- ✓ Maintain correct balance and footing. Ensure the floor is not slippery and wear non-slip footwear.
- ✓ Keep children and unauthorised persons away from the working area.
- ✓ Securely attach the press to a flat, firm, dry level surface capable of supporting the weight of press and any work piece taking into account clearance for work pieces.
- ✓ when not in use, release pressure from the hydraulic unit and clean the press. Stand or store the arbor plates in a safe location.
- ✓ Check the press for loose or damaged parts before each operation. Replace damaged parts and tighten all bolts.
- ✗ **DO NOT** operate the press if any parts are missing as this may cause failure and/or possible personal injury.
- ✗ **DO NOT** use the press for a task it is not designed to perform.
- ✗ **DO NOT** make any modifications to the press.
- ✗ **DO NOT** adjust or tamper with the safety valve.
- ✗ **DO NOT** exceed the rated capacity of the press.
- ✗ **DO NOT** apply off-centre loads.
- ✗ **DO NOT** allow the work piece or the press plates to fall from the work table.
- ✗ **DO NOT** get the press wet or use in damp or wet locations or areas where there is condensation.
- ✗ **DO NOT** operate the press when you are tired or under the influence of alcohol, drugs or intoxicating medication.
- ✗ **DO NOT** climb upon the press.
- ✗ **DO NOT** top up hydraulic unit with brake fluid, or any other fluid other than a good quality hydraulic oil (Sealey Part Number: HJO500MLS/HJO5LS) as this may cause serious damage to the hydraulic unit and will invalidate the warranty
- ✗ **DO NOT** use to compress a spring or any other item that could disengage and cause a potential hazard including personal injury.
- ✗ **DO NOT** stand directly in front of the loaded press and never leave a loaded press unattended.
- ✗ **DO NOT** allow untrained persons to operate the press.
- ✗ **DO NOT** use it for any other purpose it is not designed to perform.
- ✗ **DO NOT** use the press to compress springs or any other item that could disengage and cause a potential hazard.
- ✗ **DO NOT** exceed the ram stroke, so as not to damage the press.
- ✗ **DO NOT** expose the press to rain or any other kind of moisture.
- **WARNING!** Never stand in front of loaded press and never leave loaded press unattended.
- **WARNING!** Always wear approved eye or face protection when operating the press. A full range of personal safety equipment is available from your Sealey stockist.
- **WARNING!** Keep hands and feet away from working table area at all times.
- ✗ **DO NOT** top up hydraulic unit with brake fluid, or any other fluid other than a good quality hydraulic oil (Sealey Part Number: HJO500MLS/HJO5LS) as this may cause serious damage to the hydraulic unit and will invalidate the warranty.
- **WARNING!** Always position the press against a wall. If the press is situated in the open workshop, it is essential that a guard be placed at the rear of the unit. This will prevent injury to bystanders in the event of the work piece ejecting suddenly.
- **WARNING!** The warnings, cautions and instructions in this manual cannot cover all possible conditions and situations that may occur. It must be understood by the operator that common sense and caution are factors which cannot be built into this product, but must be applied by the operator. Ensure a safe working space of at least a metre exists around the installed unit.
- ▲ **DANGER!** The press is top heavy. If it requires moving after assembly or for relocation, use suitable slings around the top crossbeam, or lift direct with a forklift with the forks located under the top crossbeam. **DO NOT** use a pallet truck.

## 2. INTRODUCTION

Steel frame construction with 2-speed hydraulic pump unit. Sliding hydraulic ram assembly gives 245mm of lateral travel for off-centre pressing applications. Frame head fitted with ram pressure gauge. Supplied with flat pressing plate/V-blocks. Pressing plates have adjustable holds to keep plates from moving during operation.

## 3. SPECIFICATION

Model:	YK50F
Capacity:	50 Tonne
Gauge included:	Yes
Lateral Ram Travel:	245mm
Maximum Height Ram to Table:	1052mm
Minimum Height Ram to Table:	72mm
Nett Weight:	240kg
Optional Accessories:	YKSG30 - Safety Guard, YKPP8 - Press Pin Set
Overall Height:	1835mm
Ram Diameter	Ø75mm
Ram Stroke:	200mm

Table Aperture:	214mm
Working Table Width:	890mm
Working Table Depth:	233.5mm
Type:	Hydraulic

## 4. ASSEMBLY

- 4.1. YK50F 50TON PRESS ASSEMBLY (use the exploded diagram fig.1 as a guide to assembly).
- 4.1.1. Remove any loose items from the crate. Attach slings around the top cross member, using a suitable hoist or gantry lift the framework out of the transportation crate into an upright position.
- 4.1.2. Attach base sections (35) and supports (34) to the left and right posts using bolts (24), washers (25), lock washers (26) and nuts (27).
- 4.1.3. Remove the transportation bolts holding the bed frame to the posts.
- 4.1.4. Move the winch to the outside of the left hand post and attach the plate for the hand winch (22) using bolts (23), washers (21), lock and nuts (20). Ensure that the cables are located correctly in the rollers before fully tightening.

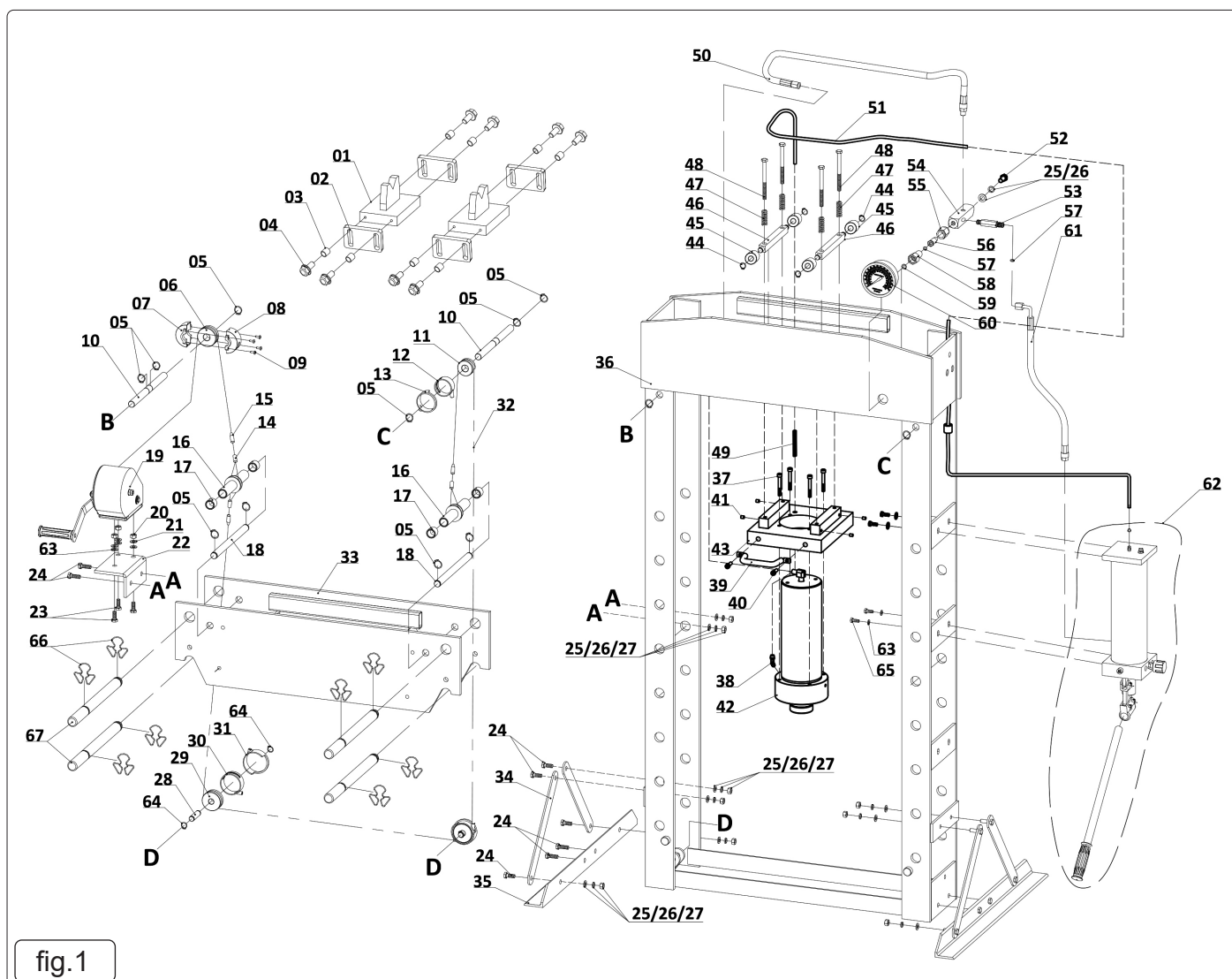

fig.1

## 5. INSTALLATION

- 5.1. Securely attach the press to a flat, firm, level surface taking into account clearance for working pieces.
- ▲ **DANGER!** The press is top heavy. If it requires moving after assembly or for relocation, use suitable slings around the top crossbeam, or lift direct with a forklift with the forks located under the top crossbeam. **DO NOT** use a pallet truck.
- 5.2. **Purge hydraulic system.**  
Before operating the press, the hydraulic system may require purging in order to eliminate any air that may have built up during transit. Open the release valve by turning anti-clockwise and pump the handle several times.  
Should the system malfunction at any time, repeating this procedure may resolve the problem.
- ▲ **DANGER!** Press's are purpose designed to withstand greater loads than the hydraulic units can develop. For safety reasons, always ensure the work piece is secured on the table to ensure loads that flex will not suddenly "give" causing danger to operator or damage to component. Ensure you have read and understood chapter 1 safety instructions.

## 6. OPERATION

- 6.1. Set the bed frame at the desired height, if adjustment is required, turn the hand winch until the cable just takes the weight of the bed frame, remove the safety clips (66) from the back of the pins (67), see Fig.3 and withdraw the pins. Use the hand winch to raise or lower the bed frame to the height required, insert pins and safety clips (Fig.4). Slacken off the hand winch so that the pins are taking the full weight of the bed frame.
- 6.2. Check that the release valve on the hydraulic unit is fully closed, ready for operation.
- 6.3. Locate the flat pressing plates or the v-blocks on to the bed frame, push down the locating pins to ensure the plates do not slip. Place work piece onto the plates and position the head of the hydraulic unit on the centre of the work piece using an appropriate extension.  
**Note:** Care must be taken to ensure the plates do not fall from the bed frame.
- **WARNING! DO NOT** apply off centre loads.
- 6.4. When work is complete turn the release valve anti-clockwise to release the pressure and the piston and the ram head will retract automatically. **Note:** Always keep the piston retracted after use.

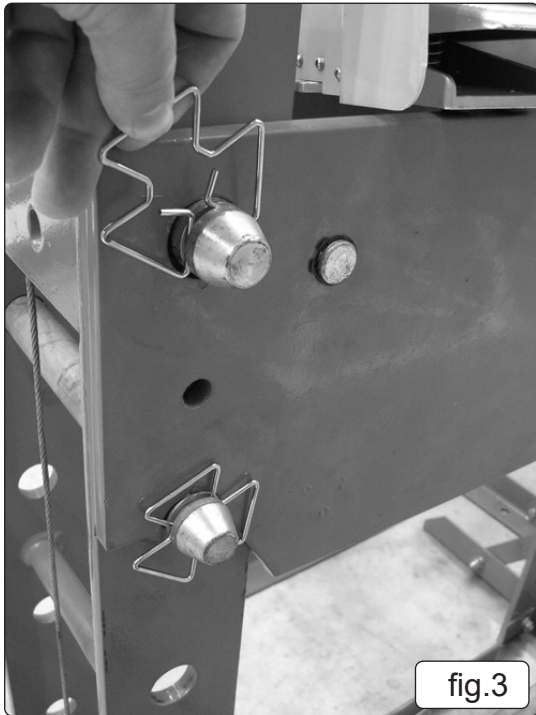

fig.3

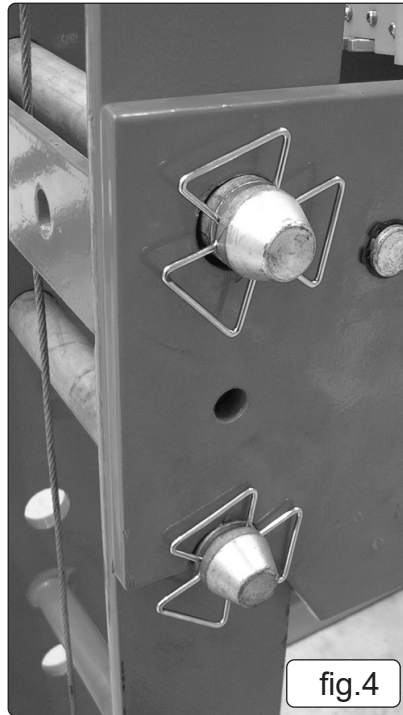

fig.4

## 7. MAINTENANCE

**NOTE:** Maintenance and repair must be carried out by qualified person. Contact your Sealey stockist for details.

- 7.1. Check all fittings are tight before each use.
- 7.2. Periodically lubricate all moving parts including the pump piston and hydraulic ram at regular intervals.
- 7.3. Always keep the press clean, dry, and protect from harsh conditions.
- 7.4. Ensure that there is adequate lighting.
- 7.5. When in not in use, store the press in a dry location with the ram and piston fully retracted.
- 7.6. Check hydraulic oil level and ensure all connections and hoses are good before use.
- 7.7. Should you need to replace the oil ensure the piston is fully retracted. An excess of oil will render the press inoperative.
- ✓ Use only appropriate Sealey hydraulic jack oil. **DO NOT** use brake fluid. Contact your local Sealey stockist for details. Purge the system to remove any air.
- 7.8. Check your model parts information for spares. Repair kits are available.
- ▲ **IMPORTANT: NO RESPONSIBILITY IS ACCEPTED FOR INCORRECT USE OF THE MACHINE.**
- ✓ Hydraulic products are only repaired by local service agents. We have service/repair agents in all parts of the UK.
- ✓ **DO NOT RETURN PRODUCT TO US.** Please telephone us on 01284 757500 to obtain the address and phone number of your local agent.
- ✓ If the product is under guarantee please contact your stockist.
- 7.9. **DE-COMMISSIONING PRODUCT**
- ✓ Should the product become completely unserviceable and require disposal, draw off the oil into an approved container and dispose of the product and the oil according to local regulations.

## 8. TROUBLESHOOTING

NO.	DESCRIPTION	CAUSE	REMEDY
1	The pump is working, but the cylinder ram is not.	1. The oil hose is loose. 2. The ram is leaking. 3. Release valve has not completely closed. 4. Air in hydraulic system.	1. Make sure oil hose connectors is tight at both ends of hose. 2. Replace the oil seals. 3. Check the release valve. 4. Purge air away. See 5.2.
2	The cylinder ram not fully working.	1. Not enough oil in pump.	1. Add oil to pump.
3	Oil leaking.	1. Oil seal is broken. 2. Screws loose on pump.	1. Replace the oil seals. 2. Tighten screws up on pump.



### ENVIRONMENT PROTECTION

Recycle unwanted materials instead of disposing of them as waste. All tools, accessories and packaging should be sorted, taken to a recycling centre and disposed of in a manner which is compatible with the environment. When the product becomes completely unserviceable and requires disposal, drain any fluids (if applicable) into approved containers and dispose of the product and fluids according to local regulations.



REGISTER YOUR  
PURCHASE HERE

**Note:** It is our policy to continually improve products and as such we reserve the right to alter data, specifications and component parts without prior notice. Please note that other versions of this product are available. If you require documentation for alternative versions, please email or call our technical team on [technical@sealey.co.uk](mailto:technical@sealey.co.uk) or 01284 757505.

**Important:** No Liability is accepted for incorrect use of this product.

**Warranty:** Guarantee is 60 months from purchase date, proof of which is required for any claim.

**Jack Sealey Ltd t/a Sealey Group**, Kempson Way, Suffolk Business Park, Bury St Edmunds, Suffolk, IP32 7AR UK  
**Jack Sealey (EU) Ltd t/a Sealey Group**, Farney Street, Carrickmacross, Co. Monaghan, A81 PK68 Ireland  
**Tel:** 01284 757500 • **Email:** [sales@sealey.co.uk](mailto:sales@sealey.co.uk) • **Web:** [www.sealey.co.uk](http://www.sealey.co.uk)